

2

1

PROPRIETARY AND CONFIDENTIAL

THE INFORMATION CONTAINED IN THIS DRAWING IS THE SOLE PROPERTY OF NEUTRONICS ENTERPRISES INC., AND SHALL NOT BE COPIED, DISCLOSED TO THIRD PARTIES, OR USED FOR ANY PURPOSE OTHER THAN THE SPECIFIC PURPOSE FOR WHICH IT WAS PROVIDED. ANY REPRODUCTION IN PART OR AS A WHOLE WITHOUT THE WRITTEN AUTHORIZATION OF NEUTRONICS ENTERPRISES INC. IS PROHIBITED.

REVISION HISTORY

| REV.  | DESCRIPTION      | DATE       | APPROVED |
|-------|------------------|------------|----------|
| 2023A | INITIAL RELEASE  | 04/06/2024 | JK       |
| 2024C | MATERIAL UPDATES | 09/15/2024 | JK       |

B

B



3X 90° PATTERN THREADS  
M6 x Ø 55mm  
M5 x Ø 55mm  
M5 x Ø 40mm

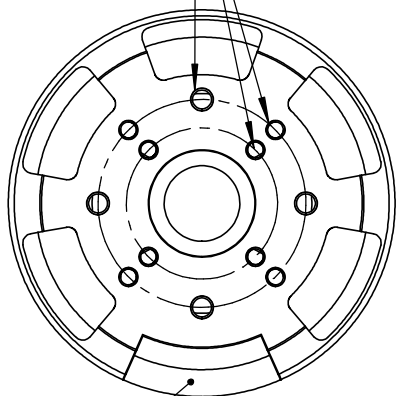
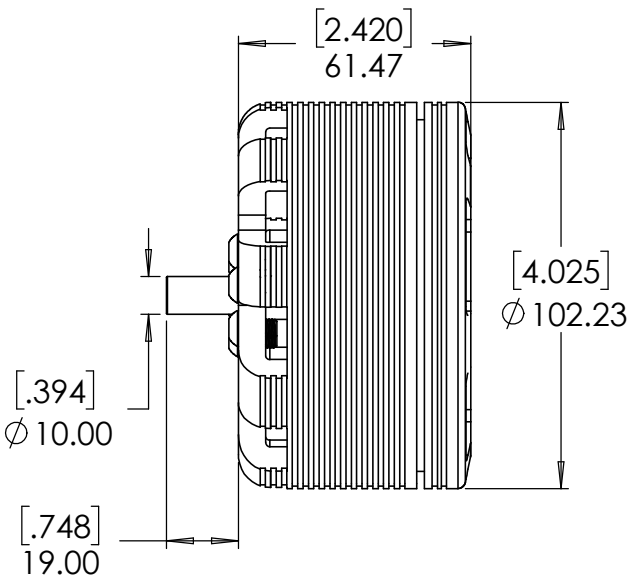
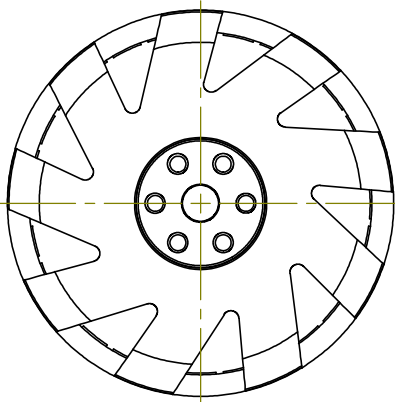

WIRES EXIT HERE

A

A

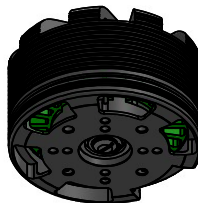

- NOTES
1. DIMENSIONS ARE IN MM AND [IN]
  2. TOLERANCES +/- 0.05mm UNLESS OTHERWISE SPECIFIED
  3. DIMENSIONS AND TOLERANCES APPLY AFTER FINISHING

**NEUMOTORS**

TITLE: W8830 ASSY -  
STANDARD MOUNT

REV: 2024C

<https://neumotors.com/> [info@neutronics.com](mailto:info@neutronics.com) SHEET 1 OF 1

2

1

2

1

PROPRIETARY AND CONFIDENTIAL

THE INFORMATION CONTAINED IN THIS DRAWING IS THE SOLE PROPERTY OF NEUTRONICS ENTERPRISES INC., AND SHALL NOT BE COPIED, DISCLOSED TO THIRD PARTIES, OR USED FOR ANY PURPOSE OTHER THAN THE SPECIFIC PURPOSE FOR WHICH IT WAS PROVIDED. ANY REPRODUCTION IN PART OR AS A WHOLE WITHOUT THE WRITTEN AUTHORIZATION OF NEUTRONICS ENTERPRISES INC. IS PROHIBITED.

| REVISION HISTORY |                  |            |          |
|------------------|------------------|------------|----------|
| REV.             | DESCRIPTION      | DATE       | APPROVED |
| 2023A            | INITIAL RELEASE  | 04/06/2024 | JK       |
| 2024C            | MATERIAL UPDATES | 09/15/2024 | JK       |

B

B



3X 90° PATTERN THREADS  
M6 x Ø 55mm  
M5 x Ø 55mm  
M5 x Ø 40mm

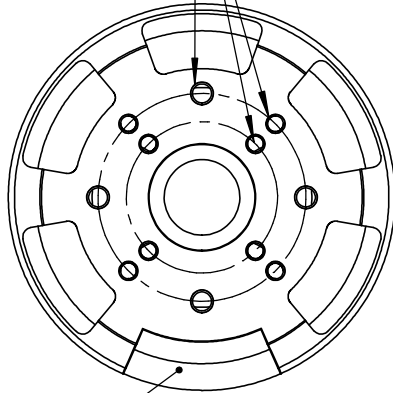
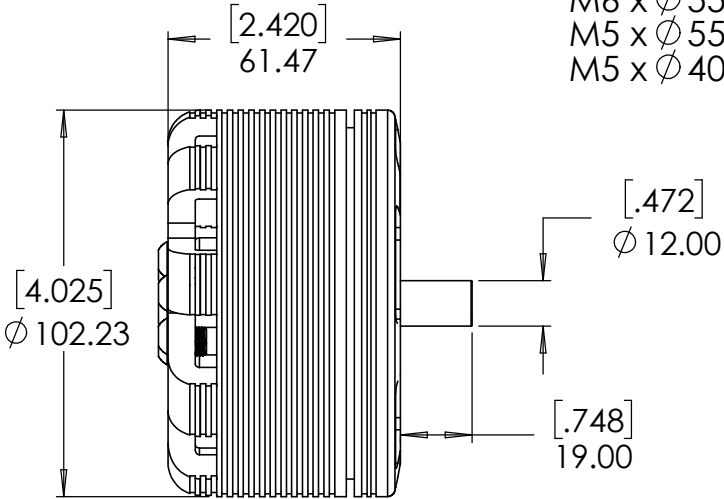
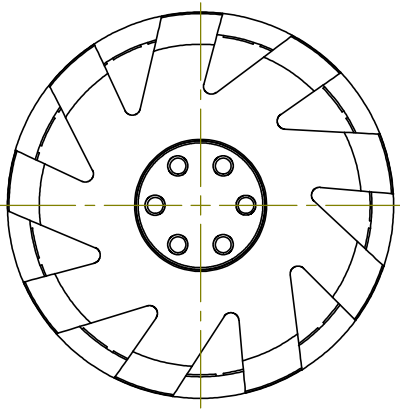

WIRES EXIT HERE

A

A

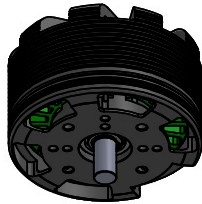

- NOTES
- 1. DIMENSIONS ARE IN MM AND [IN]
  - 2. TOLERANCES +/- 0.05mm UNLESS OTHERWISE SPECIFIED
  - 3. DIMENSIONS AND TOLERANCES APPLY AFTER FINISHING

**NEUMOTORS**

|   |  |              |
|---|--|--------------|
| TITLE: W8830 ASSY -<br>REAR MOUNT                           |  | REV: 2024C   |
| <a href="https://neumotors.com/">https://neumotors.com/</a> | <a href="mailto:info@neutronics.com">info@neutronics.com</a> | SHEET 1 OF 1 |

2

1