

1

THE INFORMATION CONTAINED IN THIS DRAWING IS THE SOLE PROPERTY OF NEUTRONICS ENTERPRISES INC. AND SHALL NOT BE COPIED, DISCLOSED TO THIRD PARTIES, OR USED FOR ANY PURPOSE OTHER THAN THE SPECIFIC PURPOSE FOR WHICH IT WAS PROVIDED. ANY REPRODUCTION IN PART OR AS A WHOLE WITHOUT THE WRITTEN AUTHORIZATION OF NEUTRONICS ENTERPRISES INC. IS PROHIBITED.

REV.	DESCRIPTION	DATE	APPROVED
2023A	INITIAL RELEASE	05/31/2024	JK
2024C	MATERIAL UPDATES	09/14/2024	JK

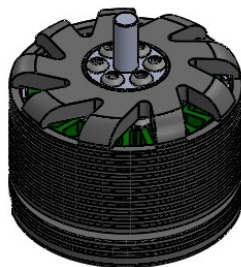

Technical drawing of a mechanical part, likely a turbine or compressor component, showing a cross-section with various dimensions. The drawing includes a central shaft with a flange and a large outer casing. Dimensions are given in brackets for specific features and as plain text for overall measurements. The central shaft has a diameter of 8.00. The outer casing has a diameter of 77.04. The total length of the component is 56.20. Other dimensions include 2.213, 3.033, 19.00, 0.748, and 0.315.

—WIRES EXIT HERE

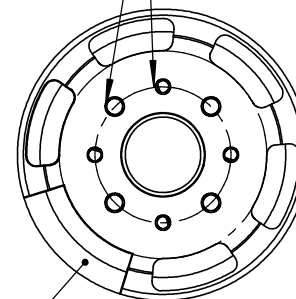
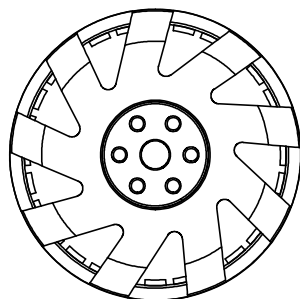

1. DIMENSIONS ARE IN MM AND [IN]
2. TOLERANCES +/- 0.05mm UNLESS OTHERWISE SPECIFIED
3. DIMENSIONS AND TOLERANCES APPLY AFTER FINISHING

NEUMOTORS

TITLE: W6530 ASSY PROFILE -
STANDARD MOUNT

REV:	2024C
------	-------

<https://neumotors.com/>

info@neutronics.com

SHEET 1 OF 1

2

1

PROPRIETARY AND CONFIDENTIAL

THE INFORMATION CONTAINED IN THIS DRAWING IS THE SOLE PROPERTY OF NEUTRONICS ENTERPRISES INC. AND SHALL NOT BE COPIED, DISCLOSED TO THIRD PARTIES, OR USED FOR ANY PURPOSE OTHER THAN THE SPECIFIC PURPOSE FOR WHICH IT WAS PROVIDED. ANY REPRODUCTION IN PART OR AS A WHOLE WITHOUT THE WRITTEN AUTHORIZATION OF NEUTRONICS ENTERPRISES INC. IS PROHIBITED.

REVISION HISTORY

REV.	DESCRIPTION	DATE	APPROVED
2023A	INITIAL RELEASE	05/31/2024	JK
2024C	MATERIAL UPDATES	09/14/2024	JK

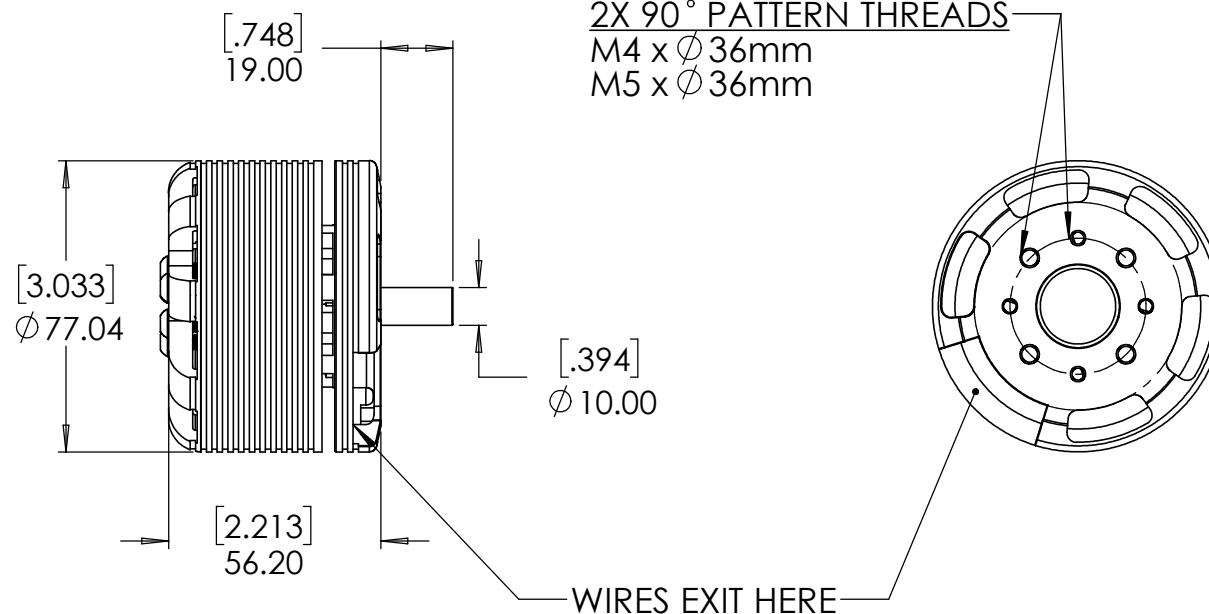
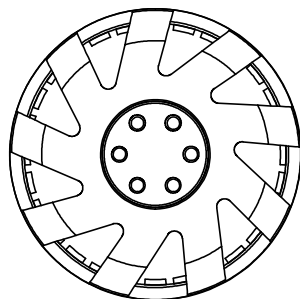

NOTES

1. DIMENSIONS ARE IN MM AND [IN]
2. TOLERANCES +/- 0.05mm UNLESS OTHERWISE SPECIFIED
3. DIMENSIONS AND TOLERANCES APPLY AFTER FINISHING

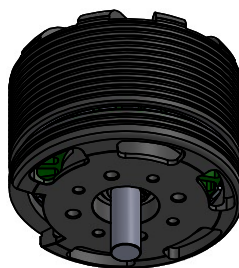

NeuMotors

TITLE: W6530 ASSY PROFILE -
REAR MOUNT

REV: 2024C

<https://neumotors.com/>

info@neutronics.com

SHEET 1 OF 1

2

1