

2

1

PROPRIETARY AND CONFIDENTIAL

THE INFORMATION CONTAINED IN THIS DRAWING IS THE SOLE PROPERTY OF NEUTRONICS ENTERPRISES INC., AND SHALL NOT BE COPIED, DISCLOSED TO THIRD PARTIES, OR USED FOR ANY PURPOSE OTHER THAN THE SPECIFIC PURPOSE FOR WHICH IT WAS PROVIDED. ANY REPRODUCTION IN PART OR AS A WHOLE WITHOUT THE WRITTEN AUTHORIZATION OF NEUTRONICS ENTERPRISES INC. IS PROHIBITED.

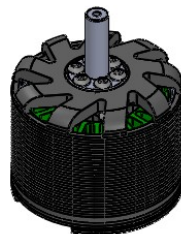

REVISION HISTORY

REV.	DESCRIPTION	DATE	APPROVED
2023A	INITIAL RELEASE	07/05/2024	JK
2024C	MATERIAL UPDATES	09/12/2024	JK

B

B

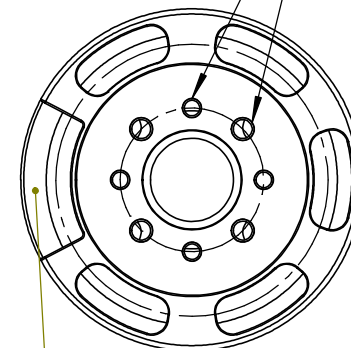
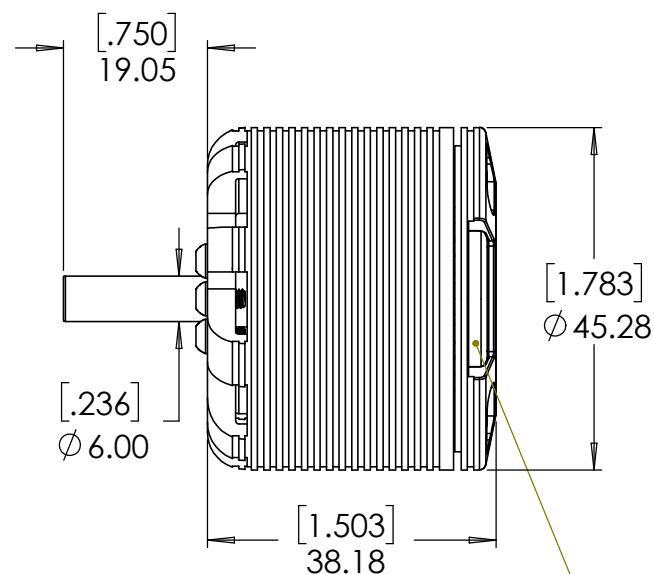
2X 90° PATTERN THREADS
M2.5 x ϕ 19mm
M3 x ϕ 19mm



WIRES EXIT HERE

A

A

NOTES

1. DIMENSIONS ARE IN MM AND [IN]
2. TOLERANCES +/- 0.05mm UNLESS OTHERWISE SPECIFIED
3. DIMENSIONS AND TOLERANCES APPLY AFTER FINISHING

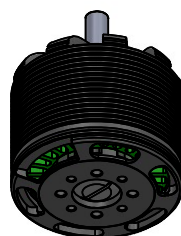

NEUMOTORS

TITLE: W3825 ASSY PROFILE -
STANDARD MOUNT

REV: 2024C

<https://neumotors.com/>

info@neutronics.com

SHEET 1 OF 1

2

1

2

1

PROPRIETARY AND CONFIDENTIAL

THE INFORMATION CONTAINED IN THIS DRAWING IS THE SOLE PROPERTY OF NEUTRONICS ENTERPRISES INC., AND SHALL NOT BE COPIED, DISCLOSED TO THIRD PARTIES, OR USED FOR ANY PURPOSE OTHER THAN THE SPECIFIC PURPOSE FOR WHICH IT WAS PROVIDED. ANY REPRODUCTION IN PART OR AS A WHOLE WITHOUT THE WRITTEN AUTHORIZATION OF NEUTRONICS ENTERPRISES INC. IS PROHIBITED.

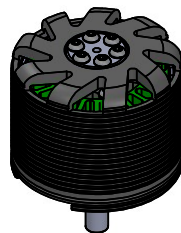
REVISION HISTORY

REV.	DESCRIPTION	DATE	APPROVED
2023A	INITIAL RELEASE	07/05/2024	JK
2024C	MATERIAL UPDATES	09/12/2024	JK

B

B

2X 90° PATTERN THREADS
M2.5 x ϕ 19mm
M3 x ϕ 19mm

WIRES EXIT HERE

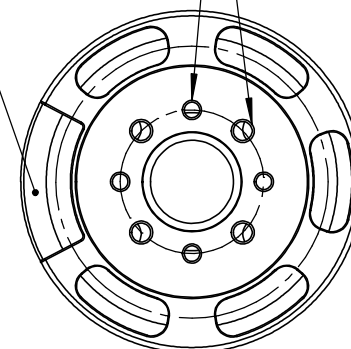
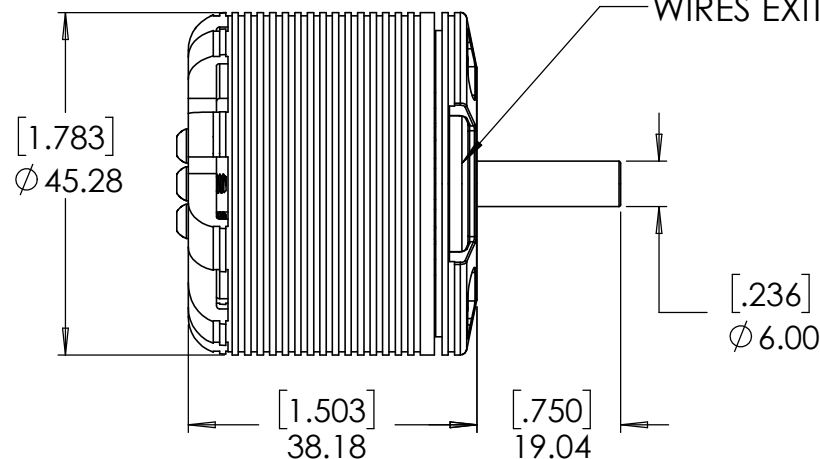
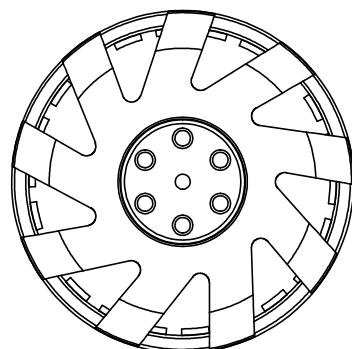

A

A

NOTES

1. DIMENSIONS ARE IN MM AND [IN]
2. TOLERANCES +/- 0.05mm UNLESS OTHERWISE SPECIFIED
3. DIMENSIONS AND TOLERANCES APPLY AFTER FINISHING

NEUMOTORS

TITLE: W3825 ASSY PROFILE -
REAR MOUNT

REV: 2024C

<https://neumotors.com/>

info@neutronics.com

SHEET 1 OF 1

2

1